



NOTES:
 This drawing is the copyright of Arktec Ltd and has been sent to you in confidence. It must not be reproduced or disclosed to third parties without our prior permission.
 Do not scale from this drawing except for planning purposes.
 All dimensions are in millimetres unless noted otherwise.
 Any surveyed information incorporated on this drawing cannot be guaranteed as accurate unless confirmed by a fixed dimension.
 This drawing is to be used in conjunction with all the relevant conditions, schedules and manufacturers drawings and information.

MATERIAL LEGEND

-  Facing brickwork
-  7.5N/m²r blockwork
-  Internal non-loadbearing partition with insulation between

NOTE: BLOCK STRENGTHS TO BE IN STRICT ACCORDANCE WITH ENGINEERS ADVICE

GENERAL LEGEND

- FHB = Full Height Boiling
- MLB = Medium level Boiling
- LLB = Low level Boiling
- SYP = 50k Vent Pipe
- FS = Floor Socket
- RWP = Rain Water Pipe
- DI = Door 1
- 838FD20 = 20 Minutes Fire Resistance
- 838FD30(S)SC = 30 Minutes Fire Resistance (Smoke Seal & Intumescent Strip), Self-Closing Door
- W2 = Window 2
- MJ = Movement Joint (in accordance with engineers details)

STRUCTURAL SUPPORT / STEEL REQUIREMENTS

Structural support shown indicative only, refer to engineers drawings & specification

Positions in accordance with engineers drawings & specification

NOTE: ALL STEELWORK MUST BE SUPPLY PROTECTED WITH INTUMESCENT FRANK OR ENCASED WITH PLASTERBOARD TO ENSURE 30 MINUTES FIRE RESISTANCE IS ACHIEVED IN STRICT ACCORDANCE WITH THE MANUFACTURERS RECOMMENDATIONS

ALL VOIDS BETWEEN STEELS & FLOOR BEAMS TO BE CROUCHED BY FLOOR SPECIALIST

FLOOR AREAS (GROSS INTERNAL)

Lower Ground	Ground Floor	FBI Floor	Total
142.7m²	142.7m²	439.54m² (4231.24dfl)	725.0m²
Note: For sales purposes all floor areas in rooms/roof are taken to 150mm high outdoor wall line.			

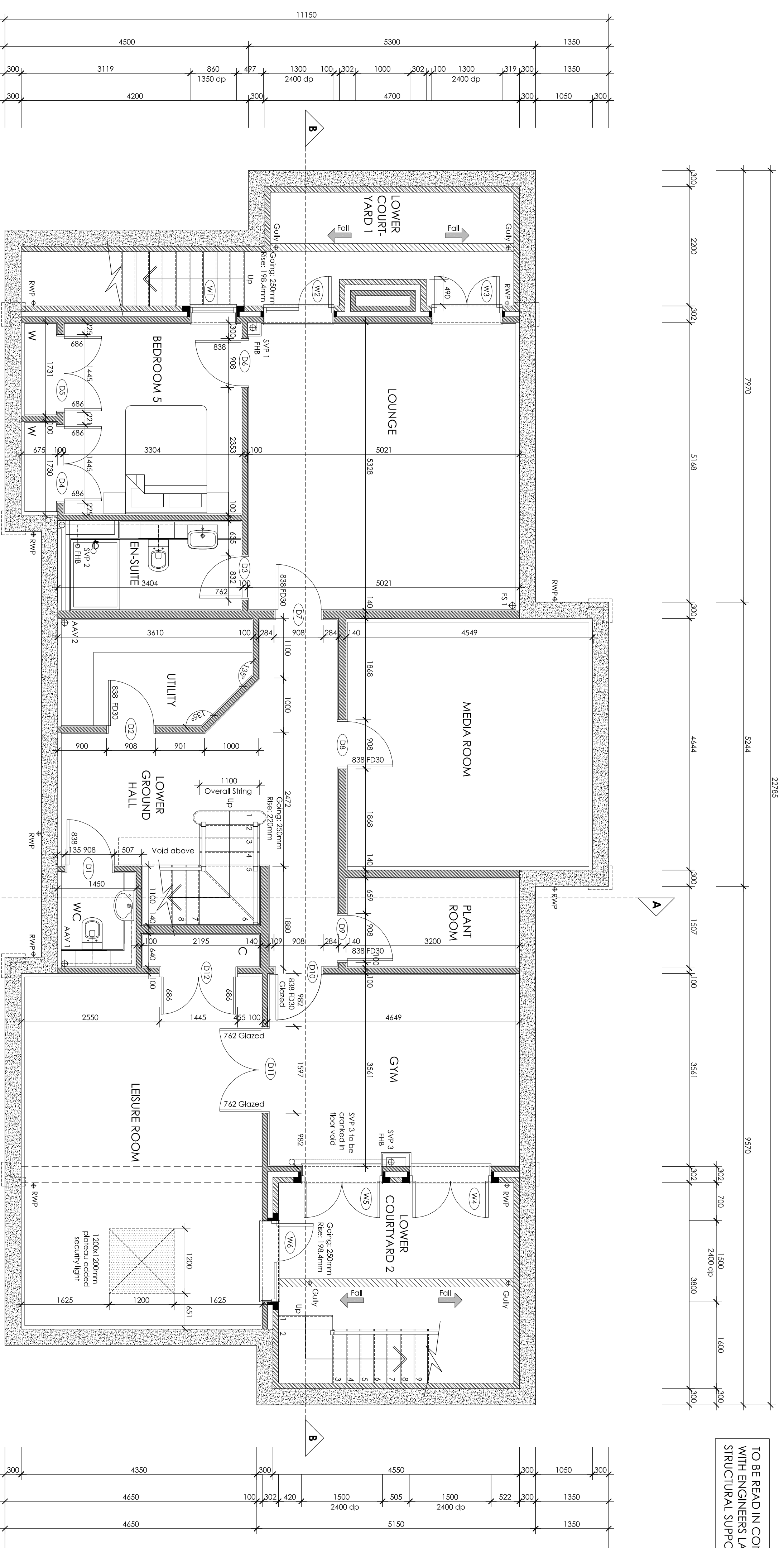

LOWER GROUND FLOOR PLAN

ark|tec Client: BRIDGEWATER NEW HOMES
 Architectural Consultancy Project: SILVERWOOD, WAYERLEY DRIVE, VIRGINIA WATER,
 1 Farnham Road Drawing: LOWER GROUND
 Sunley Floor Plan
 G02/4RG Scale: 1:50 @ A1 Date: 07/12/12
 T: 01483 549 047
 F: 01483 549 100
 E: info@arktec.co.uk
 W: www.arktec.co.uk

Rev	Date	Details
C	11/01/13	Plant room added; D11 amended
B	08/01/13	Utility amended; WC and Cupboard added in Gym/Hall area
A	04/01/13	External wall in Media Room amended; External staircase in Lower Courtyard 2 amended

PRELIMINARY

Drawing Number: **T12/25/110** Revision: **C**